

- No.1 Install “BIG EYE” according to the instruction manual.(figure 1)**
No.2 Install supporting leg assembly of “S-12S” , as shown in the figure 2 (step 1).
No.3 Install cantilever assembly of “S-12S” , as shown in the figure 2 (step 2).

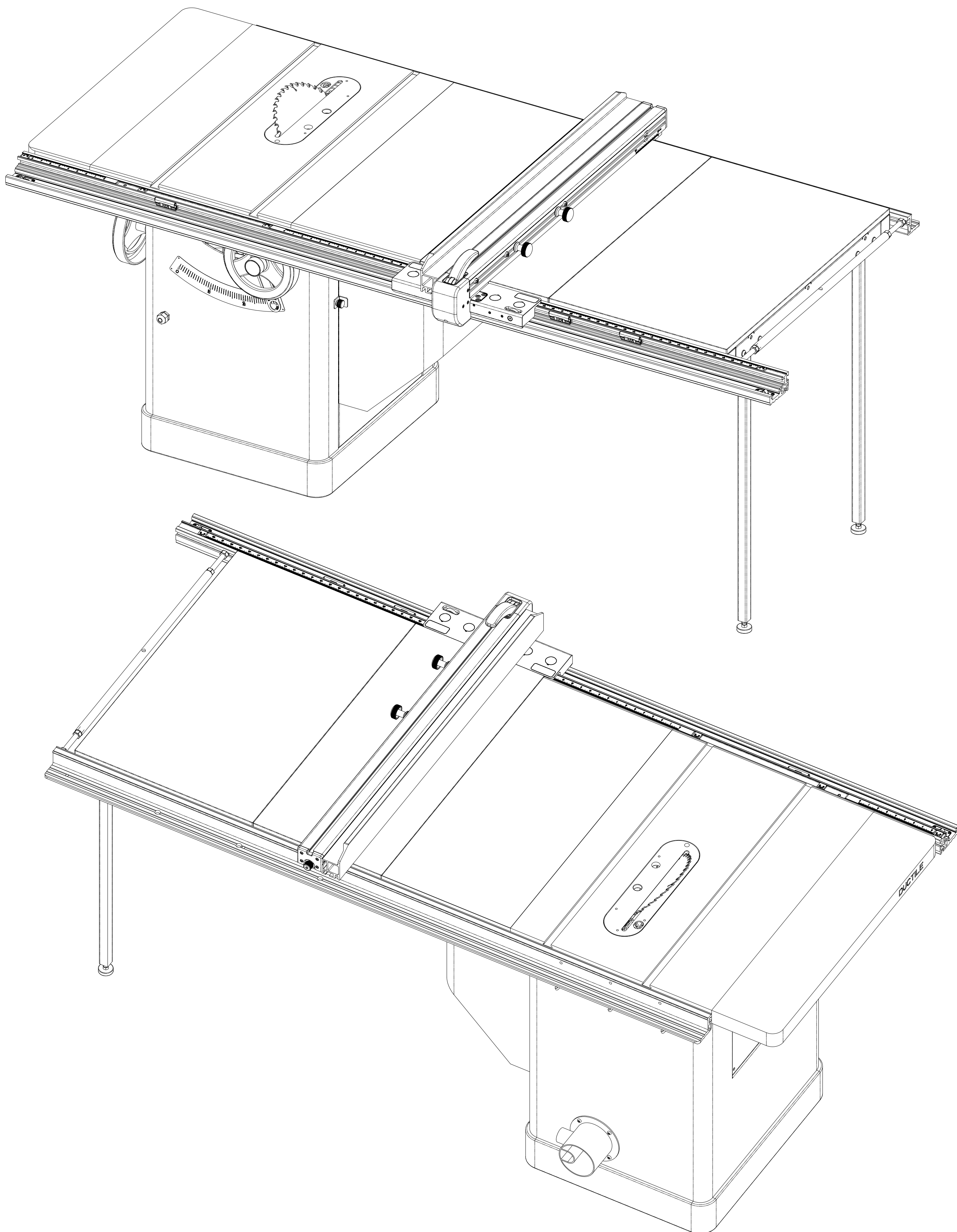
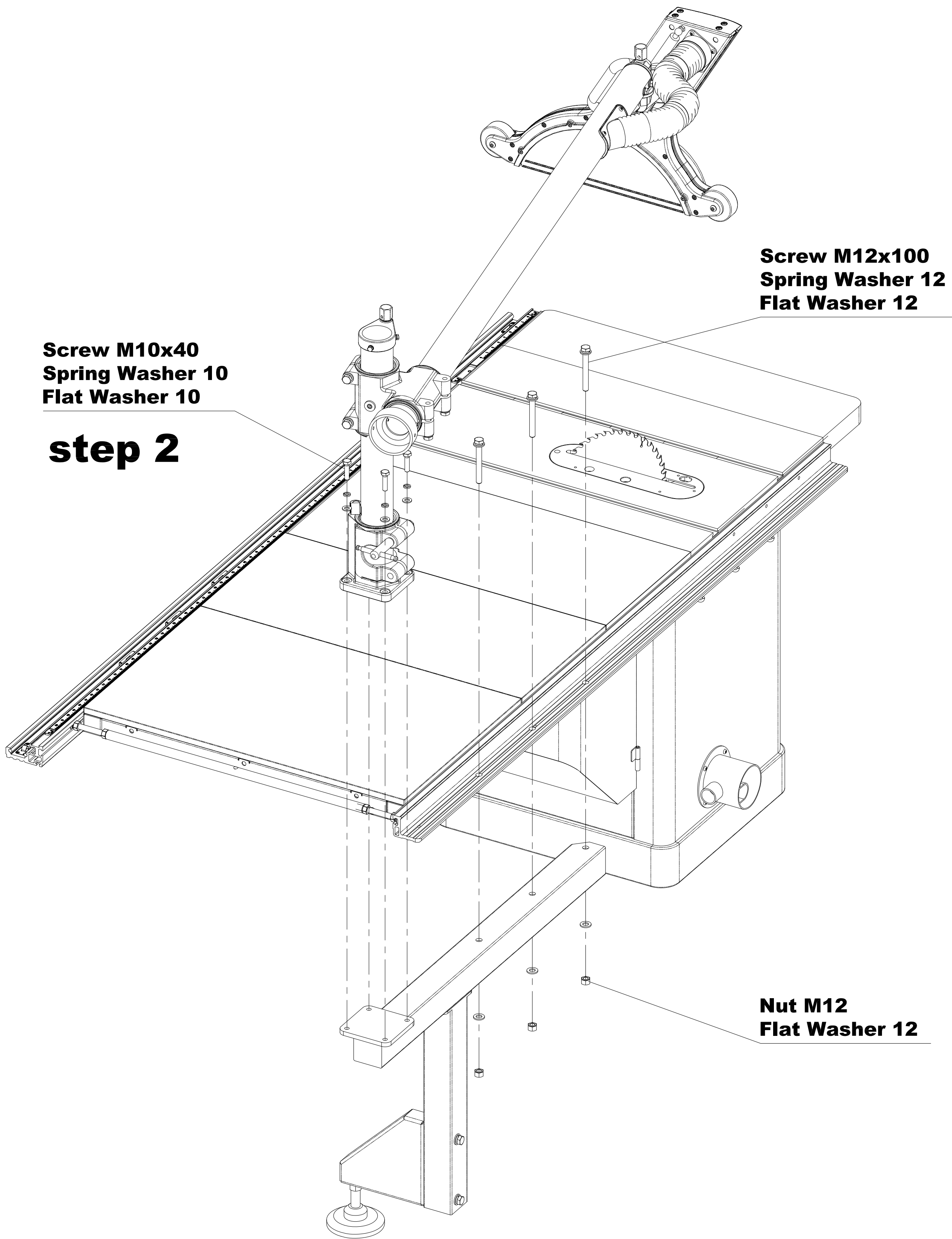

figure 1



step 1

**Screw M10x40
Spring Washer 10
Flat Washer 10**

step 2

**Screw M12x100
Spring Washer 12
Flat Washer 12**

step 1

**Nut M12
Flat Washer 12**

figure 2